

FLOOR PLAN

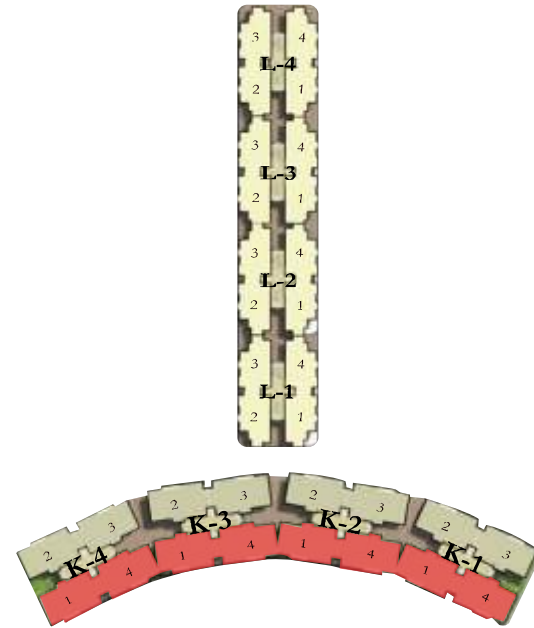

3 BHK - TYPE I

Tower K1, K2, K3 & K4 (Unit 01 & 04)

AREA	SQ. FT	SQ. M
Saleable Area	1380	128.21
Built-Up + Balcony	1134.10	105.36
Carpet Area	942.60	87.57

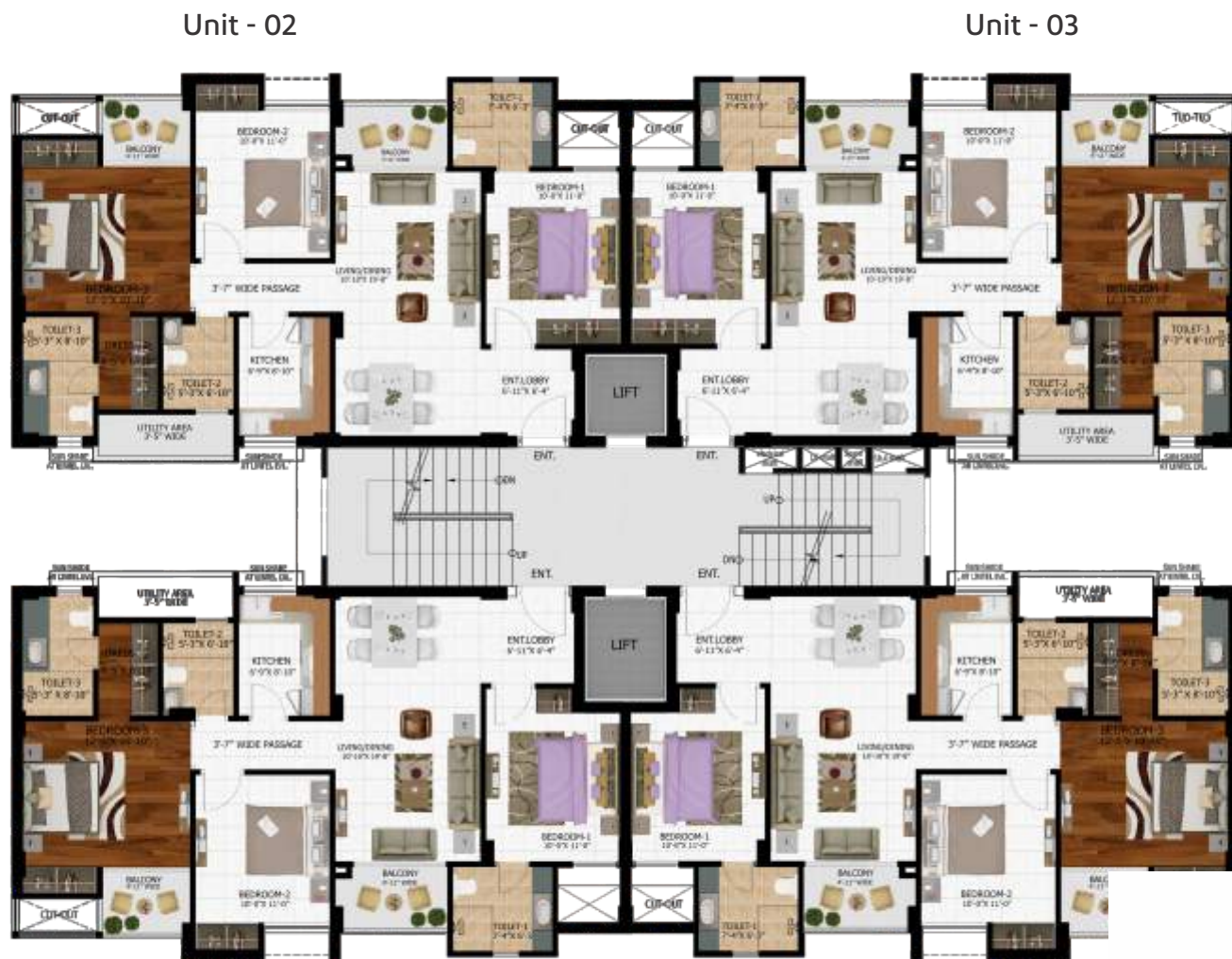

Unit - 01

Unit - 04



Unit - 01